

5100/5101  
FLB/FLB+  
Panel Convector

**CONVECTAIR**



*We value your feedback!*

Your input helps to create even better products and experiences.

Share the warmth and leave a review.  
[convector.com/sharethewarmth](https://convector.com/sharethewarmth)

 [YouTube/Convector](https://www.youtube.com/Convector) 



## INSTALLATION AND USER'S GUIDE

To be read and kept by the user.



# Foreword

---

Dear owner,

Congratulations on the purchase of your new **CONVECTAIR** electric heater.

To obtain the best results and the ultimate in performance and comfort, please take a moment to read the installation, operation and maintenance instructions detailed in this manual.

## **WARNING :**

If your unit is equipped with a high precision electronic thermostat (FLB + models), it should not be connected to a wall thermostat.

# Summary

---

Important Instructions .....	4
Quick Start .....	6
Characteristics .....	7
Location Recommendations .....	8
Installation and Securing.....	10
Electrical Wiring.....	12
How to Use Your Convectair FLB heater.....	13
How to Use Your Convectair FLB+ heater .....	13
Day and Time Configuration.....	13
Setting the Temperature Unit Display .....	14
Setting the Set Temperature.....	14
Programming Daily Settings.....	15
Adaptive Start .....	16
Key lock .....	16
Thermal Protection .....	17
Maintenance .....	17
Identifying Your Device.....	18
Warranty .....	19

# Important Instructions

---

When using electrical appliances, basic precautions should always be followed to reduce the risk of fire, electric shock and injury to person, including the following:

1. THESE INSTRUCTIONS SHOULD BE READ CAREFULLY AND RETAINED FOR FUTURE REFERENCE. Note also the information presented on the appliance.  
**CAUTION:** FAILURE TO FOLLOW THESE INSTRUCTIONS MAY CAUSE INJURY AND/OR DAMAGE AND MAY VOID YOUR WARRANTY.
2. SUITABLE APPLICATIONS.  
**WARNING:** This heater is suitable for normal domestic household purposes and should not be used in any other type of environment. This product should only be used in the country where it is purchased from by a recognized commercial retailer. Do not use outdoors.
3. Do not operate any heater after it malfunctions. Disconnect power at the service panel and have the heater inspected by a reputable electrician before using.
4. To disconnect the heater, turn the controls to the OFF position, and turn off the power to the heater circuit at the main disconnect panel.
5. To prevent a possible fire, do not block the air intakes or exhaust in any manner.
6. A heater has hot and arcing or sparking parts inside. Do not use it in areas where gasoline, paint, or flammable vapors or liquids are used or stored.



**WARNING:** In order to avoid overheating, do not cover the heater.

7. This heater is hot when in use. To avoid burns, do not let bare skin touch hot surfaces. Keep combustible materials, such as furniture, pillows, bedding, papers, clothes, etc. and curtains at least 3 ft. (0.9 m) from the front and sides of the heater.
8. Use this heater only as described in this manual. Any other use not recommended by the manufacturer may cause fire, electric shock, or injury to persons.
9. **IMPORTANT:** The heater must not be located immediately below a socket-outlet.
10. **WARNING:** The FLB series heaters are not equipped with a device to control the room temperature. Do not use this heater in small rooms when they are occupied by persons not capable of leaving the room on their own, unless constant supervision is provided.
11. **CAUTION:** Some parts of this product can become very hot and cause burns. Particular attention has to be given where children and vulnerable people are present.

# Important Instructions

---

12. This appliance can be used by children aged from 8 years and above and persons with reduced physical, sensory or mental capabilities or lack of experience and knowledge if they have been given supervision or instruction concerning the use of the appliance in a safe way and understand the hazards involved. Children shall not play with the appliance. Cleaning and user maintenance shall not be made by children without supervision.
13. Children of less than 3 years should be kept away unless continuously supervised.
14. Children aged from 3 years and less than 8 years shall only switch on/off the appliance provided that it has been placed or installed in its intended normal operating position and they have been given supervision or instruction concerning the use of the appliance in a safe way and understand the hazards involved. Children aged from 3 years and less than 8 years shall not plug in, regulate and clean the appliance or perform user maintenance.

**SAVE THESE INSTRUCTIONS**

# Quick Start

---

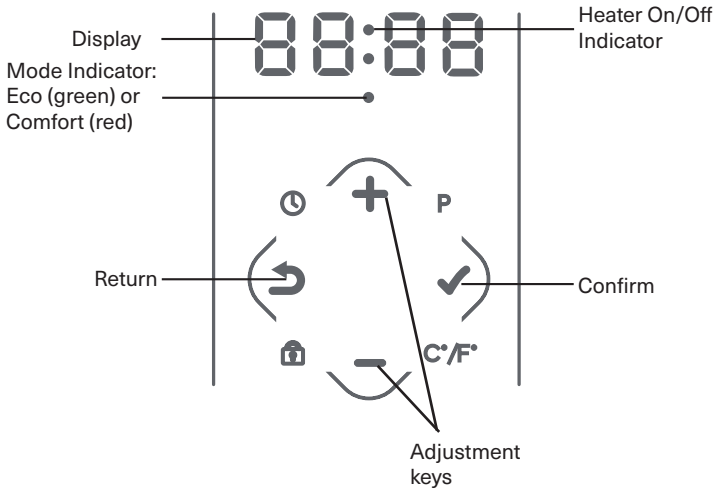

---

## Turning the Heater On or Off (FLB and FLB+ models):

Press the toggle switch on **I** to turn heater on, or on **O** to turn it off.

## Setting the Temperature:

Using the adjustment keys, increase or decrease the temperature according to the desired comfort.

## Heat Mode (Eco and Comfort):

Press **↶** to toggle between Comfort and Eco modes. The Mode Indicator is green when in Eco mode and red when in Comfort mode.

## Lock the Controls

Press **↶** and **-** simultaneously to lock (*LOCd*) or unlock (*DPEn*) the controls.

# Specifications

Model	Series	Total Power	Voltage	Width (mm)	Height (mm)	Depth (mm)	Weight (kg)
5101-C05-BB	FLB+	500 W	240 V	425 (16 5/8")	400 (15 3/4")	115 (4 1/2")	2.7 (6 lb)
5100-C05-BB	FLB						
5101-C10-BB	FLB+	1000 W		525 (20 3/4")			3.8 (8.4 lb)
5100-C10-BB	FLB						
5101-C15-BB	FLB+	1500 W		625 (24 5/8")			3.8 (8.4 lb)
5100-C15-BB	FLB						
5101-C20-BB	FLB+	2000 W		825 (32 1/2")			4.2 (9.3 lb)
5100-C20-BB	FLB						

# Location Recommendations

---

## **PLEASE READ CAREFULLY:**

These instructions are essential for safe installation and use of your **CONVECTAIR** unit.

- The installation must comply with the national and local standards in place and CONVECTAIR recommends that it be performed by a master electrician.
- Your appliance must be installed in such manner that switches and other control devices cannot be touched by a person in the bathtub or in the shower. Do not install over a bath or any other container of water.
- Do not install behind a door, cabinet or box, or in front of an air extractor. Keep combustible fabrics, such as curtains, away from heaters.
- Avoid positioning a window sill, behind curtains, doors, or under an air extractor.
- Your appliance has a heating element which gets very hot. Do not install or use in the presence of gasoline, paint, or near flammable products.
- The device must not be installed under a power outlet.
- The wall bracket supplied with the heater must be used.
- Do not install the product if it is damaged.



## Recommendations and advice

### CAUTION :

Do not insert anything into the unit.

The first time the heater is turned on, there may be an odor. This phenomenon disappears after a few minutes of operation.

### CAUTION: DO NOT COVER

There is a risk of overheating if the device is covered. It is therefore strictly forbidden to cover or block the air inlet or outlet grilles at the risk of incidents or damage to the device.

**Do not cover the heater.**

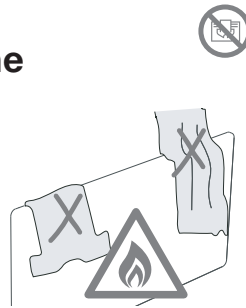

Respect the minimum installation distances to the floor, walls, furniture, etc. (Fig. 1).

**CAUTION: DO NOT INSTALL THE BOTTOM LESS THAN 58 mm (2 po) ABOVE THE FLOOR, THE SIDES LESS THAN 30 mm (1.2 po) AND THE TOP LESS THAN 300 mm (12 po) FROM ANY SURFACE**

Fig. 1

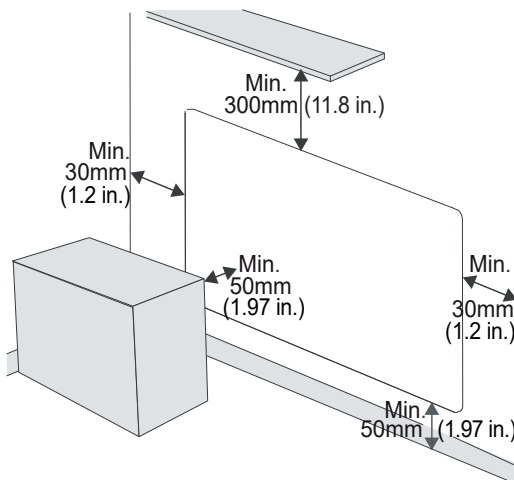

# Installation and Mounting

## TOOLS REQUIRED



(4) 1 1/2" Screws

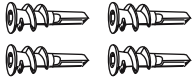

(4) Wall anchors (if needed):  
must be suitable for  
min. 50 lb / 22.7 kg



Wire Connectors



Stud Finder  
(Optional)

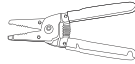

Wire Strippers

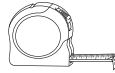

Tape Measure

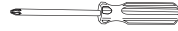

#2 Phillips  
Screwdriver



Utility Knife



Level

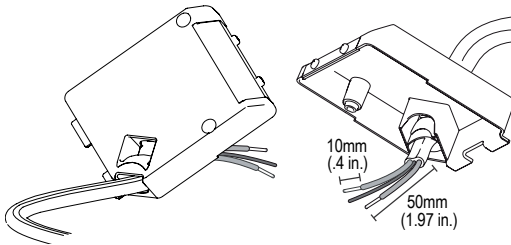

1. Insert the supply cable through the strain relief of the installation cover. Remove 1.97 inches (50 mm) of the outer insulation, and .4 inches (10 mm) of the inner insulation.

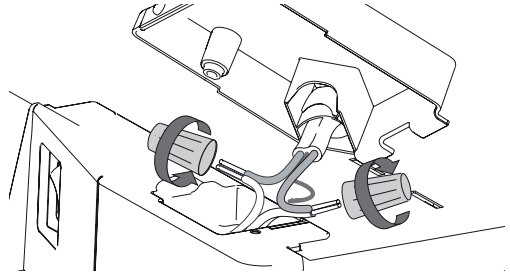

3. Cut two 30 mm pieces of the insulating sleeve and slide over the line wires of the supply cable. Connect each lead to the corresponding wires on the heater, using the wire nuts provided (see *Electrical Wiring*, page 12.)

**! NOTE:** The insulating sleeve, supplied with the product, must be placed over the exposed line wires of the supply cable.

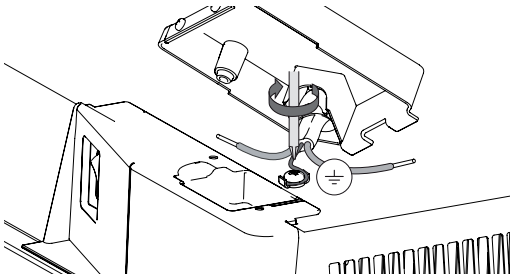

2. Connect the grounding wire to the chassis using the designated grounding screw.

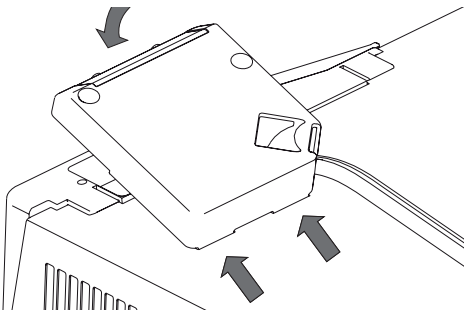

4. Insert the two tabs of the installation cover into the two slots in the chassis and fold the cover over the wiring.

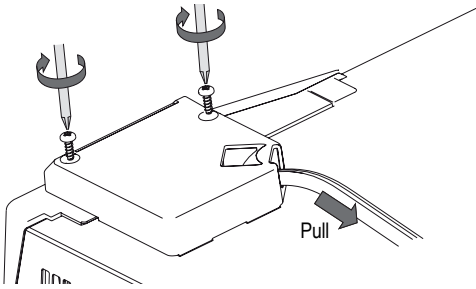

5. Fasten the installation cover with the two screws. Make sure the supply cable is securely fastened by firmly pulling it.

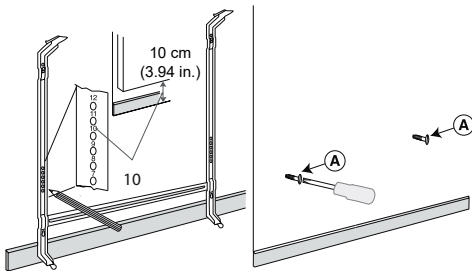

6. The wall bracket can be used as a measuring device for placing the heater on the wall. Mark the location for the two bottom screws (A-A) and fasten the two screws in the wall.

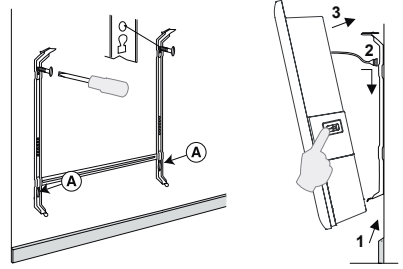

7. Place the wall bracket onto the bottom screws (A-A). Then fasten the wall bracket with the top screws. Place the heater on the wall bracket (1), secure the tilt strap (2) and click the heater onto the top catches (3).

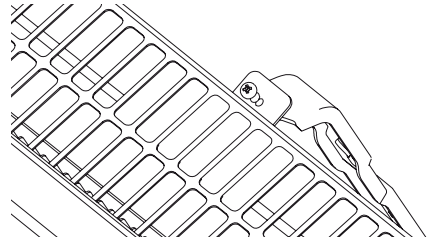

8. For additional safety, secure the heater safely to the wall. Fasten a screw (not included) on each of the two catches at the top of the wall bracket.

# Electrical Wiring

- **CONVECTAIR** recommends that devices be installed by a master electrician, in accordance with applicable national and local codes.
- The device must be connected to a 240 volt, 60 cycle circuit. Disconnect the power before making any connections to avoid electric shock or damage to the device.
- To avoid short circuits, turn off the power at the electrical panel before any installation or repair.
- If the power supply wires of the device are damaged, they must be replaced by the manufacturer, its after-sales service, or a similarly qualified person in order to avoid a danger.



## CONNECTION DIAGRAM

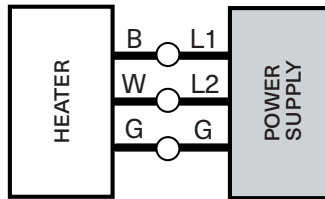

**B=BLACK W=WHITE G=GREEN L1=LINE 1 L2=LINE 2 G=GROUND**

- Turn off the power to the heater before opening.
- This heater must be grounded.
- A circuit breaker is necessary for the installation; do not load it to more than 80% of its capacity.
- Secure the device to the back bracket before turning it on.

# How to Use Your Convectair FLB Heater

FLB panel convectors do not have integrated controls. They must be controlled using a properly sized wall thermostat, which must be purchased separately.

## How to Use Your Convectair FLB+ Heater

### DAY AND TIME CONFIGURATION

**NOTE :** when switching on for the first time (or after a fairly long power outage) 00:00 is displayed, the time must be set.

After each intervention on the controls, after 5s the time display returns.

Press + and ↶ simultaneously.

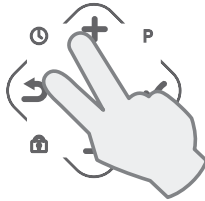

E. Set the minutes (press + or -)

15:00

A. Select 12H/24H (press +)

24:00

F. Confirm (press ✓)

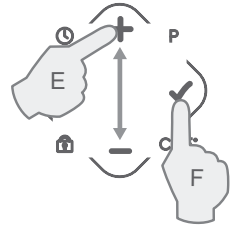

B. Confirm (press ✓)

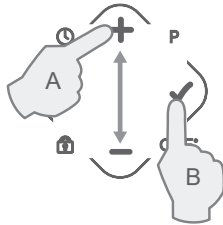

G. Set the day (press + or -)

d1:00

C. Set the hour (press + or -)

00:00

d1: Monday  
d2: Tuesday  
d3: Wednesday  
d4: Thursday  
d5: Friday  
d6: Saturday  
d7: Sunday

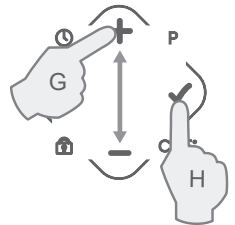

D. Confirm (press ✓)

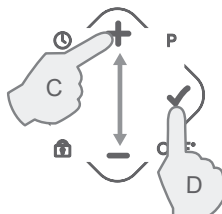

H. Confirm (press ✓)

## SETTING THE TEMPERATURE UNIT DISPLAY

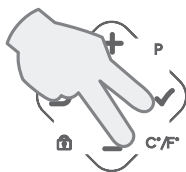
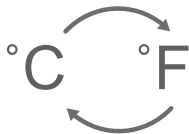

Press - and ✓  
simultaneously.

## SETTING THE SET TEMPERATURE

The heater can be set:

either in **Comfort** mode (for setting the desired temperature)

or in **Eco** mode (recommended for short absences)

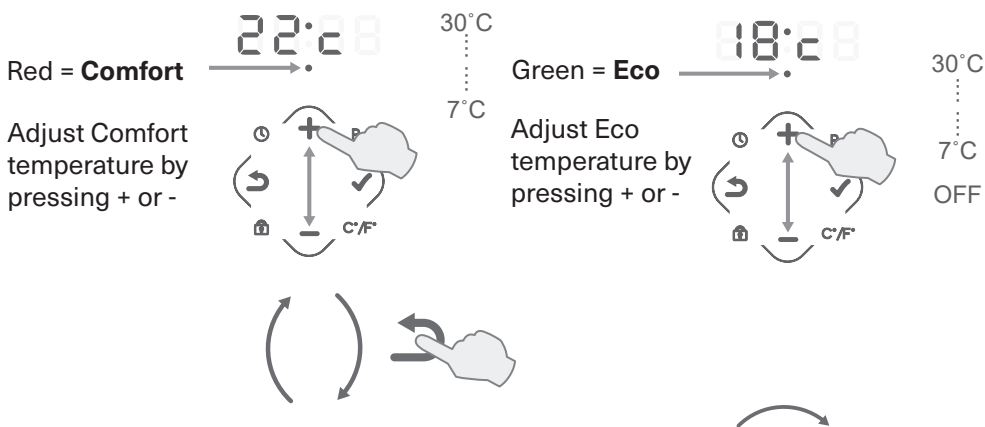

Pressing  $\curvearrowright$  overrides the status from  
Comfort to Eco or vice versa.

The override is terminated automatically  
upon the next event in the program, or at  
03:00.



A centre dot in the numerical  
display will flash when the heater  
is heating

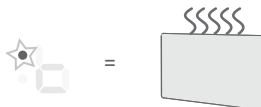

## PROGRAMMING DAILY SETTINGS

This heater has nine 24-hour programs. Select one program for each day of the week.

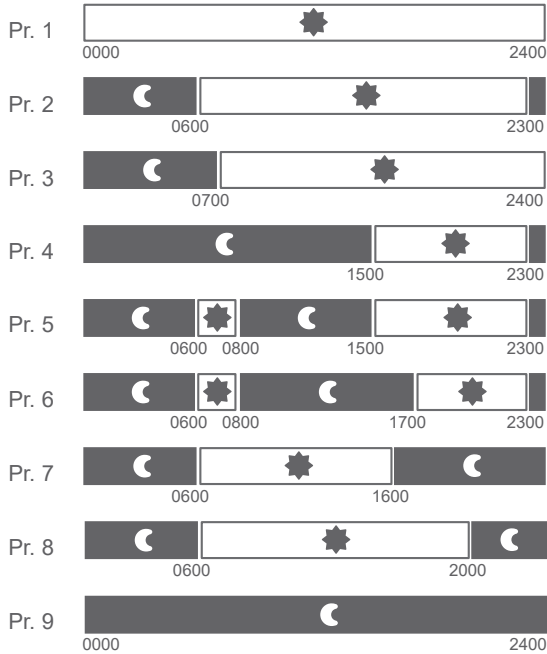

Press ✓ and + simultaneously.

A. Select from above programs for day 1 (Monday) (press + or -)

B. Confirm (press ✓)

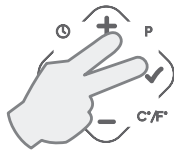

d1:P1

d1: Monday

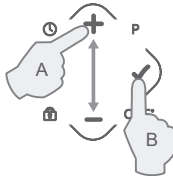

C. Now select from above programs for day 2 (Tuesday) (press + or -)

D. Confirm (press ✓)

Repeat for each day (d1 to d7)

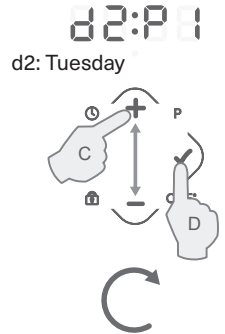

## ADAPTIVE START

---

Adaptive start allows the heater to learn what time it needs to start heating so that the room is at the set temperature by the time of the programmed setting. For example, if the programming is set to 20 degrees Celsius at 6am, the heater will start heating up before 6am so that by 6am, the room will be 20 degrees Celsius.

**i** Many factors impact on room heat up times (e.g. size of the room and insulation) and initially the heater may start too early or too late. However it will learn and recalibrate itself over several days optimising itself to the best time to start heating.

## KEY LOCK

---

**i** This function allows you to block access to the device settings to prevent inadvertent modifications.

Press **↵** and **-** simultaneously to lock (**L o c k**) or unlock (**O P E n**).

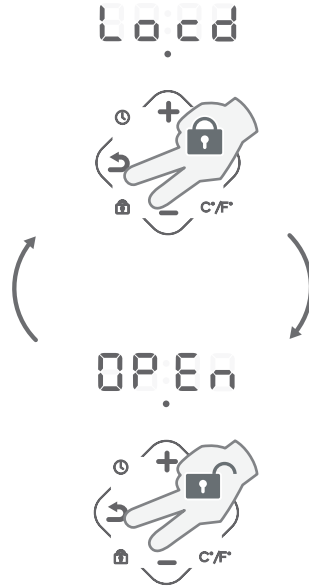



# Overheat Protection

---

Should the heater overheat, an automatic thermal cut out will turn the heater off. The heater will reactivate once the heater has cooled. It will continue to cycle on and off automatically until the reason for overheating is removed.

In the event of abnormal operation, turn off the device. Check that the grilles are not blocked. Clean if necessary.

# Maintenance

---

**WARNING:** Disconnect power and allow the unit to completely cool before attempting any maintenance or cleaning to reduce the risk of fire, electric shock, or injury to persons.

To keep the appliance clean, regular maintenance is recommended. To remove dust, use a soft cloth. To remove a stain, dampen the cloth.

For best performance and maximum efficiency of the appliance, it is recommended to regularly remove dust and debris that may accumulate on the grilles of the FLB/FLB+ panel convector.

**NEVER USE ABRASIVE OR ACETONE-BASED PRODUCTS, AS THEY COULD DAMAGE THE EPOXY COATING.**

**ALL SERVICING ON CONVECTAIR APPLIANCES MUST BE CARRIED OUT WITH THE POWER OFF, AND BY QUALIFIED AND AUTHORIZED PERSONNEL.**

## Recommendations and advice

Your **CONVECTAIR** appliance becomes hot during use. Particular care must be taken in order to inform young children.

Do not insert objects into the openings of the grilles; this could cause short circuits, fires, or damage to devices.

Any other use not recommended by **CONVECTAIR** may cause short circuits, fires, or injury to users.

In some conditions, the grille of the devices may turn yellow after some time. This phenomenon is not due to a manufacturing defect. Rather, it is caused by the ambient air which contains fumes or suspended particles, which are heated and then exhausted through the grille. This phenomenon is particularly visible on «pure white» devices and can cause severe discoloration.

**Prevention: it is advisable to clean the grills frequently, especially for appliances installed in places exposed to cigarette smoke or in the kitchen. CONVECTAIR devices must never be used during construction work or other activities which generate a lot of dust.**

When switching on the **CONVECTAIR** for the first time, a slight smoke may emerge from it. This phenomenon is quite normal and will go away on its own after 2 or 3 minutes of operation of the device.

## Identifying Your Device

### IMPORTANT: PRODUCT INFORMATION APPEARS ON THE RATING LABEL.

The rating label allows for identification of the heater, and is placed on the back of the unit near the supply grille.

It includes:

- The complete model number (A), which must be included in any warranty claim.
- Its power in Watts (B).
- Standard certification (C).



# Warranty

---

## **2 years against all defects / 10 years on the heating element.**

### **Please keep your purchase and/or installation invoice.**

The Manufacturer warrants the convector heater and components of the enclosed product against any defect in material or workmanship for a period of two years from the date of purchase, with the exception of the elements which are warranted to be free from defect in material and workmanship for ten years. In full satisfaction of any claims under this Warranty the Manufacturer will repair or replace without charge, in its factory or in the field as it alone may decide, any parts which in its opinion are defective.

The Manufacturer shall not be responsible for any transportation or shipping costs in relation to such repair or replacement except as specifically assumed by it. Misuse of this product or repairs by persons other than the Manufacturer's authorized personnel without the Manufacturer's written approval, will void this Warranty.

This Warranty is in lieu of all other warranties or conditions whether expressed or implied including but not limited to those of merchantability or fitness for purpose and shall constitute the sole remedy of the Purchaser and the sole liability of the Manufacturer in respect of the sale of the product, whether in the nature of breach or breach of fundamental term, or of negligence or otherwise.

The Manufacturer shall not be liable for any special, indirect or consequential damages or for any damages resulting from removal or replacement of a convector heater subject to warranty claim without the Manufacturer's authorization.

Any claims under this Warranty must be submitted in writing to the Service Manager, Glen Dimplex Americas Ltd., 1367 Industrial Rd., Cambridge, Ontario N3H 4W3, Canada.

---

### **SERVICE CENTERS:**

To find the nearest Service Center, visit our website ([www.convectair.ca](http://www.convectair.ca)) or contact CONVECTAIR customer service at the following number: **1 800 463-6478**

---

## We value your feedback!

Your input helps to create even better products and experiences.

Share the warmth and leave a review.  
[convectair.com/sharethewarmth](https://convectair.com/sharethewarmth)

 [YouTube / Convectair](https://www.youtube.com/Convectair) 



1-888-346-7539 | [www.dimplex.com](http://www.dimplex.com)

In keeping with our policy of continuous product improvement, we reserve the right to make changes without notice.

© 2020 Glen Dimplex Americas

 A BRAND OF GLEN DIMPLEX AMERICAS